

LegendMEDI tent

In compliance with MSF standards

Medical structure with haemorrhagic fever inner rooms

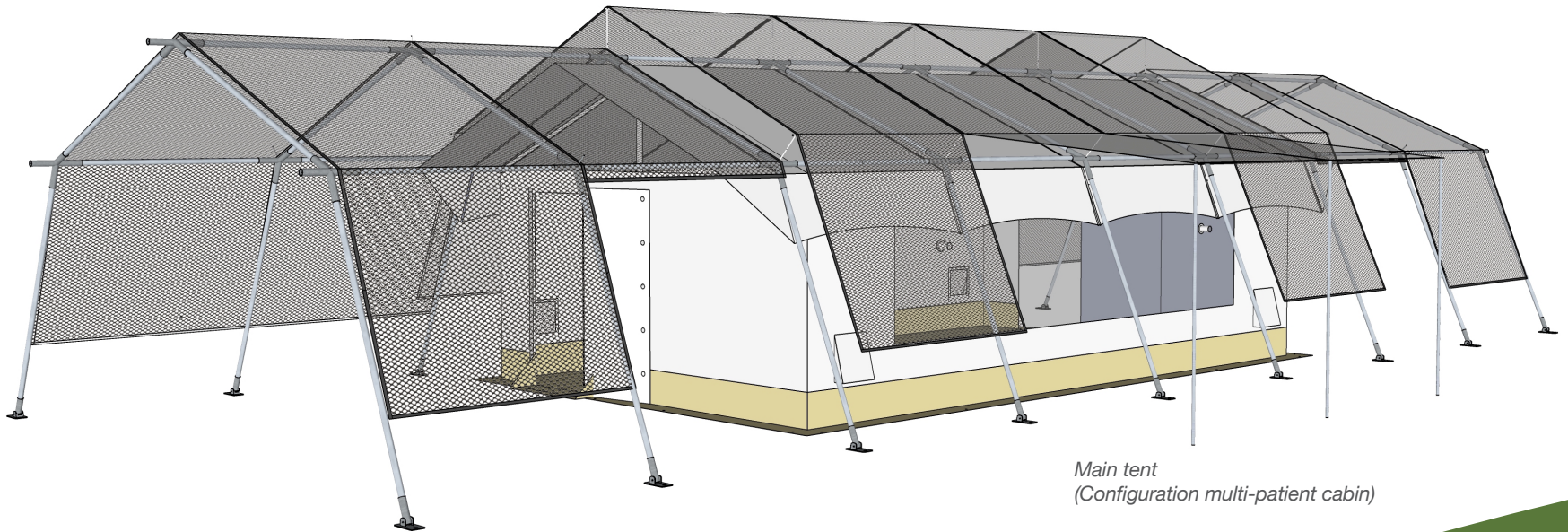

*Main tent
(Configuration multi-patient cabin)*



Configuration 4
isolation cabins



Frame

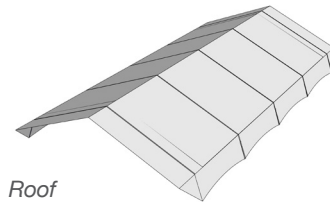

Roof

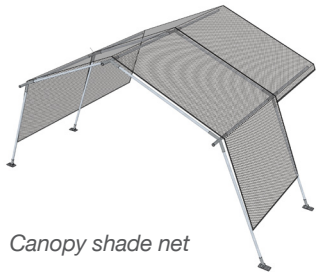

Canopy shade net

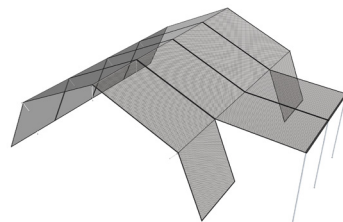

Shade net



This tent is designed in response to the Ebola epidemic in 2014, which has cost over 11,000 lives. The medical tent can be deployed in case of haemorrhagic fever outbreaks such as Ebola and Lassa.



The LegendMEDI answers to the specific challenges when treating haemorrhagic fever patients.



It offers solutions such as treatment and isolation rooms for both suspected and confirmed patients.



The individual cabins for suspected patients prevent cross-contamination between infected and healthy patients.



The medical tent is constructed in a way no (infected) material can accumulate on the surface of the tent, in seams or other parts.



The tent is designed to allow freedom of movement and easy operation like opening/closing of the doors with magnetic closures, wearing protective clothing.



The special treatment cabins and other accessories are made of PVC coated polyester or polyethylene tarpaulin with non-corrosive accessories, whereby all seams and attachment points which might get in touch with patients, are heat or HF welded.



All tent components can be disinfected with chlorine-based disinfectants or other commonly used detergents.



It can be erected on various soil conditions and in different climate conditions, from moderate to tropical.

Configurations



Cabin for **confirmed** patients

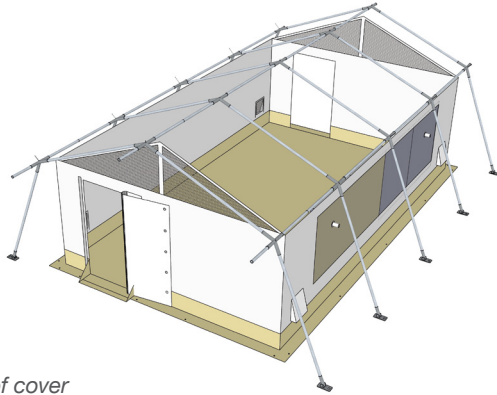

Main tent + Roof cover



Main tent + Extended shade net

Main tent with individual cabin

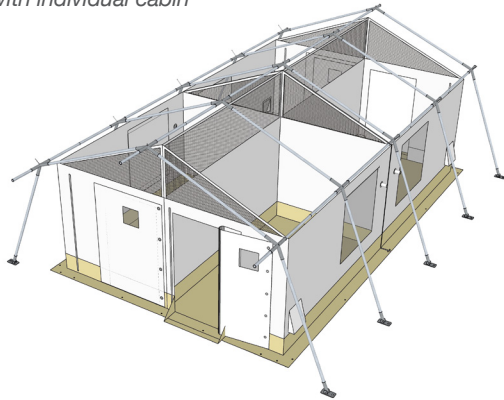

Main tent with multiple patients cabin



Cabin for **suspected** patients
- 4 cabins



Materials	
<i>Isolation cabin Isolation multi-patient</i>	<ul style="list-style-type: none"> • Bathtub style groundsheet: PVC 540 gsm, FR B1, colour: sand or brown • Gables, side walls, doors and hanging points: PVC 450 gsm, FR B1, colour: white • Ventilation panels: PVC coated polyester mesh: 270 gsm, FR B1, colour: white • Side window: PVC clear film, 0.48mm super clear, FR B1
<i>Isolation cabins 4x individual treatment rooms</i>	<ul style="list-style-type: none"> • Bathtub style groundsheet: PVC 540 gsm, FR B1, colour: sand or brown • Gables, side walls, doors and hanging points: PVC 450 gsm, FR B1 for, colour: white • Ventilation panels PVC coated polyester mesh, 270 gsm, FR B1, colour: white
<i>Suspended roof panel</i>	<ul style="list-style-type: none"> • PE, 250 gsm, FR CPAI 84
<i>Partition panels</i>	<ul style="list-style-type: none"> • PVC 540 gsm, FR B1 fabric panels, colour: white • Aluminium frame construction
<i>Shade net</i>	<ul style="list-style-type: none"> • HDPE mesh, 190-195 gsm, FR treated, 80% shade ratio • Polyester webbing
<i>Canopy shade net</i>	<ul style="list-style-type: none"> • HDPE knitted mesh, 190 gsm, UV resistant, FR CPAI-84 • Polyester webbing

Dimensions

Isolation cabin	4.2 m x 7.2 m x 2 m = total floor space 30.2 m ² Door opening of 1.8 x 1 m
Isolation cabins 4x	2 cabins (2 rooms per cabin) 4.2 m x 3.5 m x 2 m = total floorspace 14.7m ² Total floorspace 2 cabins (total 4 cabins) = 29.4 m ² Total floorspace per room = 7.3m ²
Partition panels	2 m x 2 m
Shade net	6.5 m x 8 m
Canopy shade net	6.5 m x 4 m

Packing	Weight	Volume per package
Isolation cabin	55 kg	195 x 35 x 35 cm / 0.239 m ³
Isolation cabins 4x	77 kg	195 x 35 x 35 cm / 0.239 m ³
Roof panel	19 kg	195 x 23 x 23 cm / 0.103 m ³
Groundsheet	25 kg	195 x 90 x 5 cm / 0.080 m ³
Shade net + support frame	50 kg	195 x 45 x 30 cm / 0.263 m ³
Canopy shade net + frame	57 kg	195 x 45 x 35 cm / 0.307 m ³